

STRATUS-1200

Low level fog machine 1200W

Order ref: 160.448UK

User Manual



Caution: Please read this manual carefully before operating
Damage caused by misuse is not covered by the warranty



Small form factor, portable effect machine producing "dry ice" type low fog effects without the use of carbon dioxide or ice. New technology delivers a ground-hugging, flowing mist from standard fog fluid and water, perfect for stages, theatres and themed events. The main unit has a removable fluid tank and easy access water reservoir with drain tap and can be operated by a wired digital control panel, separate RF remote or 2 channel DMX connection if required.

- Produces an impressive, ground hugging mist effect
- Works using only standard fog fluid and water
- Small form factor unit for easy transportation
- 2 Channel DMX connections
- Supplied with wired digital control panel and RF wireless remote

In the box:

Please check the contents to ensure that the product has been received in good condition.

- Stratus-1200 Low Fog Machine
- Wired digital control panel
- RF wireless remote
- UK/EU Mains Leads
- User guide

If you find any accessory is missing or the machine has arrived with damage, please contact your local dealer at once. Do not try to fix this item yourself or you will invalidate the warranty. Please keep the original packaging and invoice for any possible replacement or return demands.

Warnings:

1. To prevent risk of fire or electric shock, do not expose electrical parts to water or moisture.
2. If liquids are spilled on areas other than inside the fluid tanks, disconnect the mains, allow the unit to dry out and have it checked by qualified personnel before use.
3. Avoid any impact, dropping or extreme pressure to the housing.
4. No user serviceable parts inside - do not open the case.
5. Allow the unit to acclimatise to room temperature before operating.
6. The Stratus-1200 has a built-in fluid container and reservoir so should be operated in an upright position. Ensure that the unit is positioned on a stable, non-slip surface.

Safety and Cleaning:

1. Check for correct mains voltage and condition of IEC lead before connecting to mains.
2. This unit must be earthed.
3. This unit uses a heating element – be aware that parts of the housing may be hot during use!
4. Use a soft dry or slightly damp cloth to clean the casing.
5. Do not use strong solvents for cleaning the housing.
6. Clean the fog mechanism periodically by operating with distilled water.
7. It is also recommended to use fog machine cleaning fluid (160.670UK) periodically.

Recommended Fluids:

For the Stratus-1200 fog machine, we strongly recommend the following fluid which has been specifically formulated to perform best with any heater-based fog machines.

QTX ref code	Description	Size
160.644UK	High quality fog fluid pink	1 Litre
160.583UK	High quality fog fluid pink	5 Litre

Rear Panel:

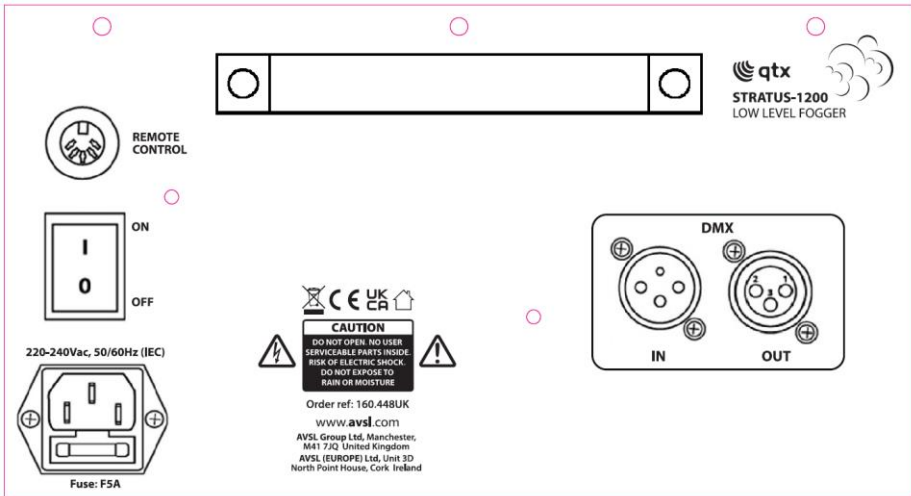

Wired Digital Control Panel:



- FUNC:** Press to scroll through menu options
- TIMER:** Press to set up the fog timer function
- UP:** Press to increase the current menu value
- START/STOP:** Press to start/stop continuous fog
- DOWN:** Press to decrease current menu value
- MANUAL:** Press and release for fog on demand

Setting Up:

1. Unpack the Stratus-1200 unit.
2. Unscrew the top cap of the tank and remove to fill with fog fluid.
3. Replace the bottle and screw the cap securely, making sure that the pipe is fed down to the bottom of the bottle to ensure a consistent flow of fluid.

4. Open the water tank cover and add water or distilled water to the reservoir ensuring you don't fill over the recommended fill line.
5. Connect the wired digital control panel to the socket marked "Remote Control" on the rear panel.
6. If DMX is to be used for control, connect the DMX signal from the controller to the DMX IN XLR connector. Any further DMX controlled units may be connected via the DMX OUT XLR connector.
7. Connect the IEC mains plug and power the unit on.
8. The unit will begin the warming up process which normally takes around 3-5 minutes.

Operation:

The LCD panel on the wired digital control panel will display the following outputs:

Function	Selection	Content
Heating status	Warming up Ready to fog	Unit is warming up please wait Unit is ready to use
Manual volume adjust	Set 1-100	Set manual fog output low to high
Interval	Set 1-900	Set continuous fog intervals low to high
Duration	Set 1-200	Set continuous fog duration
Volume	Set 1-100	Set continuous fog output low to high
Wind	Set 1-100	Set fan speed low to high
DMX512	Set 1-512	Set required DMX address

If the unit is set to DMX mode (d001-d512), the unit will operate by DMX control as follows:

Channel	Value	Content
CH1	0-255	Fan speed 0-100%
CH2	0-255	Fog output 0-100%

RF Remote Control:

The small RF remote control supplied can also be used when wireless control of the unit is needed. Ensure the wired digital control panel is connected to the unit, to use the remote for the following functions:



- A:** Continuous fog stop
- B:** Continuous fog start
- Up arrow:** Fog increase
- Down arrow:** Fog decrease

Specifications:

Power supply	220-240Vac, 50/60Hz (IEC)
Power consumption	1200W
Fuse rating	F5A
DMX Channels	2Ch
Warm up time	3-5 minutes
Remote control connection	5 pin DIN
Remote control frequency	433Mhz
Fog output (approx.)	7500 cu.ft per minute
Fluid capacity	1.2 litre (fog fluid), 3 litre (water)
Dimensions	510 x 360 x 260mm
Weight	9.3kg

Troubleshooting:

No power to main unit or wired controller	Check mains voltage is correct and socket is switched on
	Check IEC lead is OK and connected properly
	Check mains fuse in IEC connector and fuse in plug top
	If fuse blowing repeatedly, refer to qualified service personnel
Power to unit but no fog output in manual or continuous mode	Check fluid level in tank
	If fluid is OK and pump working, the lines may be blocked
	Check that output is not set to zero on the control panel
	Check that output is not switched off on the key fob remote
	If blocked, clean with fog machine cleaner & distilled water
	Check that if DMX mode is selected, the DMX channel is correct
Fog output from unit drifts upwards	In DMX mode, check that fog output is not set to zero
	Ensure you are using the correct fog fluid for the unit
	Ensure there is sufficient water in the reservoir and that its not overfilled



This product is classed as Electrical or Electronic equipment and should not be disposed with other household or commercial waste at the end of its useful life. The goods must be disposed of according to your local council guidelines.

Errors and omissions excepted.

Copyright© 2023 AVSL Group Ltd, Unit 2 Bridgewater Park,
Taylor Road, Trafford Park, Manchester. M41 7JQ.

AVSL (Europe) Ltd, Unit 3D North Point House,
North Point Bus. Park, New Mallow Road, Cork, Ireland.